



**Flake ice** is generated through a vertical cylinder, with an internal auger which scrapes the ice from the internal surface of the evaporator. This produces uniform flake ice with a residual water content

Self contained flaker on legs.  
Up to 80kg production per 24/hr of flake ice.  
25kg storage bin.  
Stainless steel cabinet.  
Complete with water & drain hoses + 1 ice scoop.  
10 AMP power supply.



## ICE PRODUCTION

### Air Cooled Unit

| Air Temp. | Water Temperature |           |           |           |
|-----------|-------------------|-----------|-----------|-----------|
|           |                   |           |           |           |
| °C        | 32°               | 21°       | 15°       | 10°       |
| °F        | 90°               | 70°       | 60°       | 50°       |
| 10°       | <b>78</b>         | <b>84</b> | <b>87</b> | <b>90</b> |
| 50°       | 172               | 185       | 192       | 198       |
| 21°       | <b>72</b>         | <b>78</b> | <b>81</b> | <b>84</b> |
| 70°       | 159               | 172       | 179       | 185       |
| 32°       | <b>58</b>         | <b>63</b> | <b>66</b> | <b>68</b> |
| 90°       | 128               | 139       | 145       | 150       |
| 38°       | <b>48</b>         | <b>52</b> | <b>54</b> | <b>56</b> |
| 100°      | 106               | 115       | 119       | 123       |

### Water Cooled Unit

| Air Temp. | Water Temperature |           |           |           |
|-----------|-------------------|-----------|-----------|-----------|
|           |                   |           |           |           |
| °C        | 32°               | 21°       | 15°       | 10°       |
| °F        | 90°               | 70°       | 60°       | 50°       |
| 10°       | <b>76</b>         | <b>81</b> | <b>84</b> | <b>86</b> |
| 50°       | 168               | 178       | 185       | 190       |
| 21°       | <b>72</b>         | <b>77</b> | <b>80</b> | <b>82</b> |
| 70°       | 159               | 170       | 176       | 181       |
| 32°       | <b>68</b>         | <b>74</b> | <b>76</b> | <b>78</b> |
| 90°       | 150               | 163       | 168       | 172       |
| 38°       | <b>64</b>         | <b>70</b> | <b>71</b> | <b>72</b> |
| 100°      | 141               | 154       | 156       | 159       |

## ICE TYPE

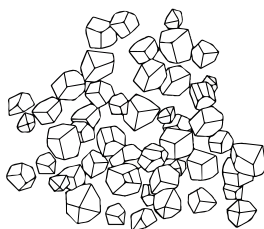

**25%**  
**FLAKE ICE**  
residual water content

Flake ice has a lot of uses, from the conservation and display of fresh fish to cocktail creation and juice bars. Flake ice is also used in hospitals and during the production of sausages and bread, to chill the mix. Flake ice is extremely versatile.

## CONTROL PANEL

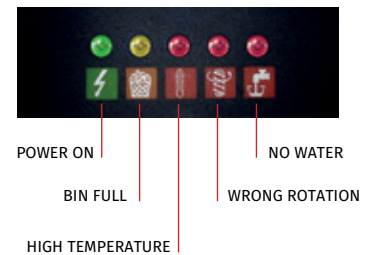

## BIN CAPACITY

20 kg - 44 lbs

## DIMENSIONS

W x D x H (mm)

570 x 600 x 690/810

640 x 660 x 870

## OPERATING REQUIREMENTS

Rejected Heat 1014 W

Air Volume 185 m<sup>3</sup>/h



220-240/50/1



R134a GWP = 1430

| MIN            |  | MAX            |
|----------------|--|----------------|
| 10°C (50°F)    |  | 40°C (104°F)   |
| 5°C (41°F)     |  | 35°C (95°F)    |
| - 10 %         |  | + 10 %         |
| 1 Bar (14 psi) |  | 5 Bar (70 psi) |



## SPECIFICATIONS

|              | <sup>+C</sup> / <sub>-C</sub> |         |        |      |           |        |    |     |    |     |                |
|--------------|-------------------------------|---------|--------|------|-----------|--------|----|-----|----|-----|----------------|
|              | cond                          | comp. W | ABS. W | Fuse | kWh/100kg | L / hr | kg | lbs | kg | lbs | Ton CO2 equiv. |
| <b>F80 A</b> |                               | 702     | 400    | 10   | 12.5      | 3.2    | 53 | 117 | 60 | 132 | 0.43           |
| <b>F80 W</b> |                               | 702     | 350    | 10   | 9.8       | 20     | 52 | 115 | 59 | 130 | 0.43           |

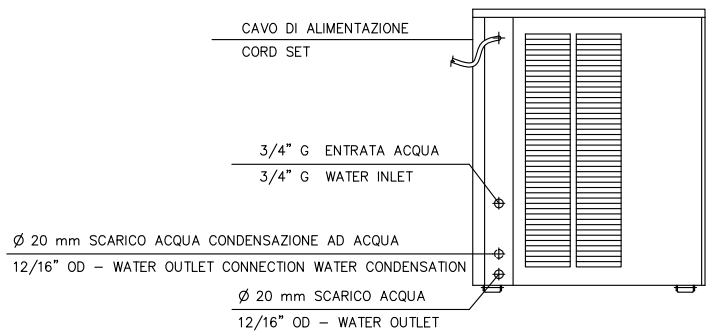
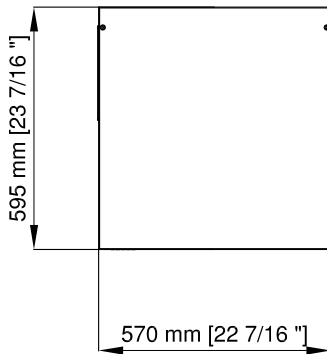
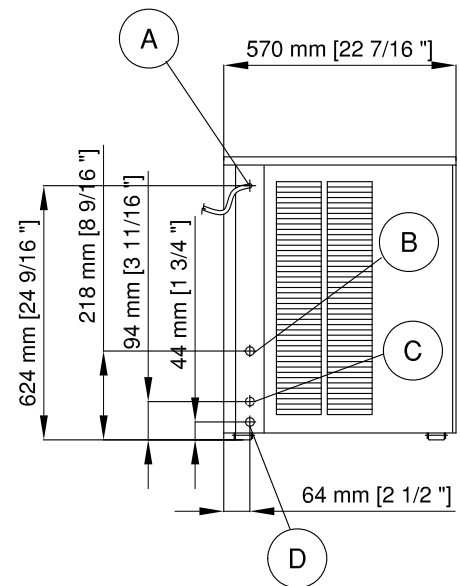
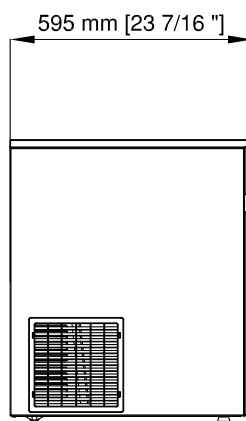
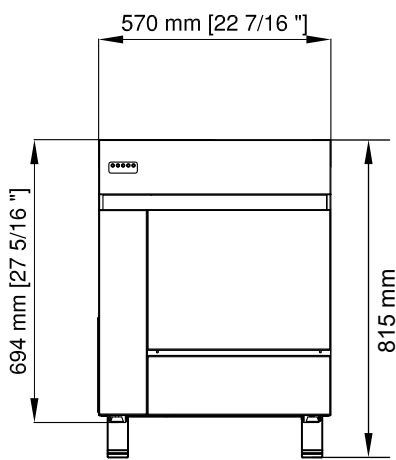

- A** Electrical cable supply
- B** Water inlet connection 3/4" gas
- C** Water outlet connection 20mm diam.
- D** Water drain 20mm diam.